

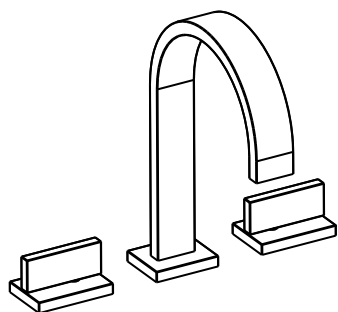

SHERLE WAGNER
architectural

INSTALLATION GUIDE

Arbor/Aqueduct/Naiad/Arco/
English Country Widespread Lavatory



101-001-BSN

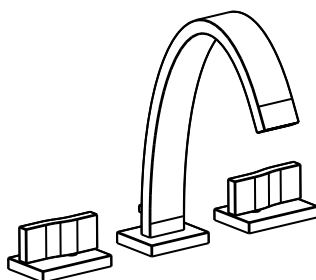

102-002-BSN

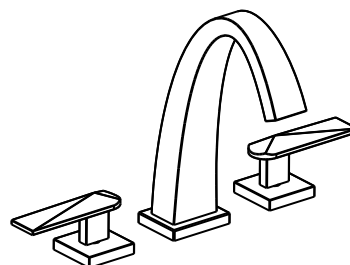

103-003-BSN

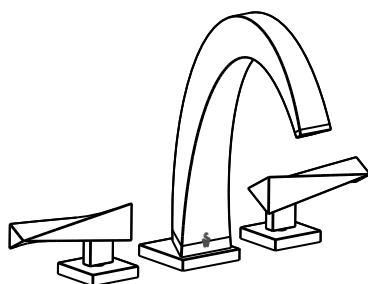

108-008-BSN

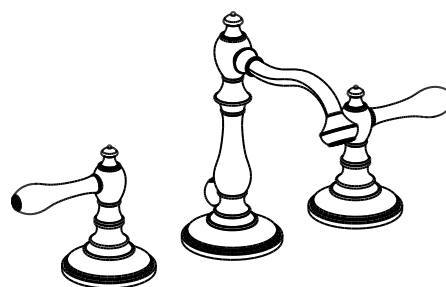

109-009-BSN

Installation tools that may be needed:

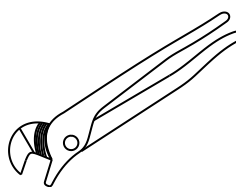
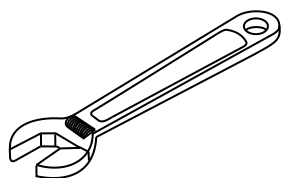

101SPT/102SPT/103SPT Spout Installation

1A

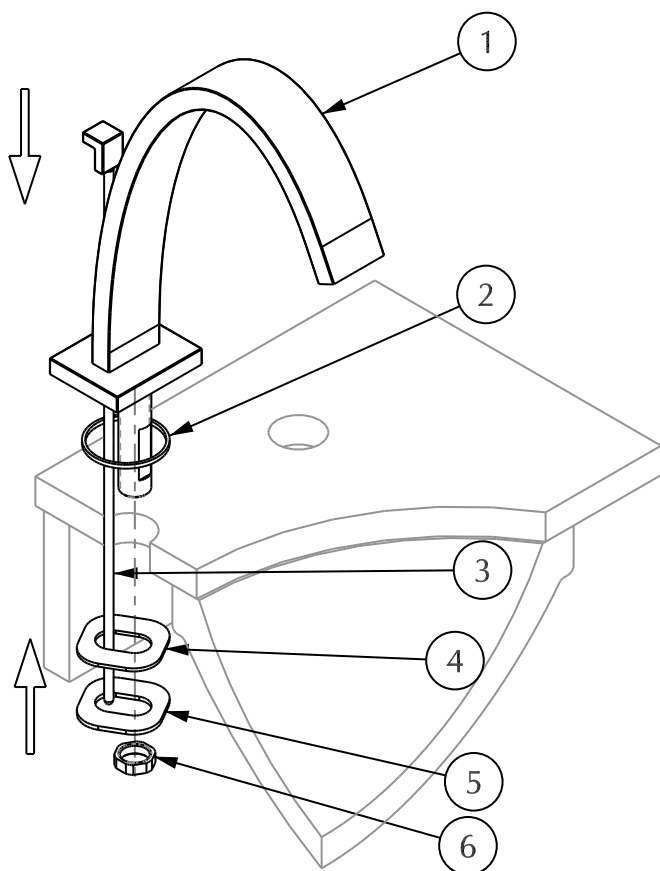

1. Insert spout assembly (1) through deck and ensure that counter gasket (2) is properly seated in spout escutcheon.
2. Insert lift rod assembly (3) through hole on back of spout.
3. Slide rubber gasket (4) and metal bracket (5) onto spout shank and thread nut (6) onto shank until spout assembly (1) is firmly in place.

2A

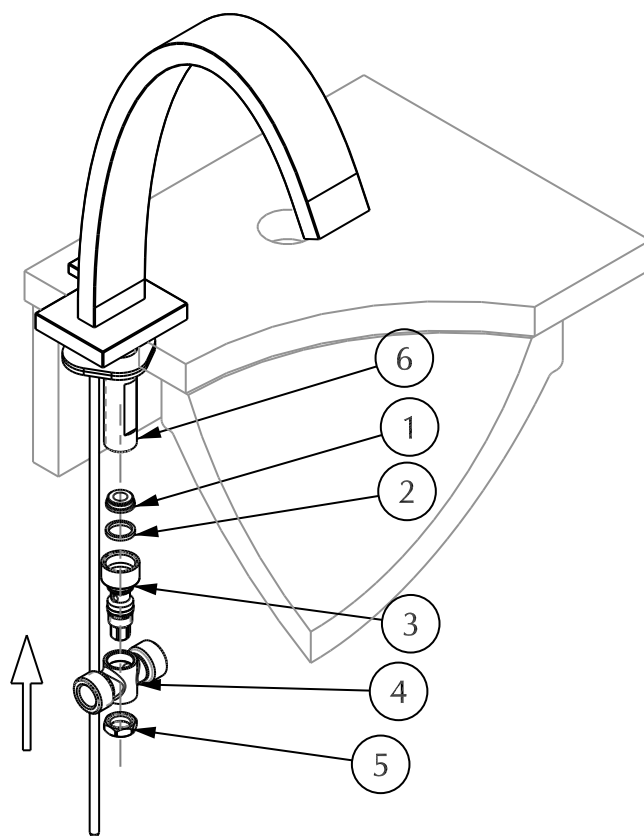

1. Place rubber gasket (2) and then metal gasket (1) into inlet nipple (3). **MAKE SURE GASKET IS PROPERLY SEATED.** Thread inlet nipple (3) onto spout shank (6).
2. Slide inlet tee (4) over inlet nipple (3) and thread nut (5) onto inlet nipple (3) until tight.

108SPT Spout Installation - With Escutcheon

1B

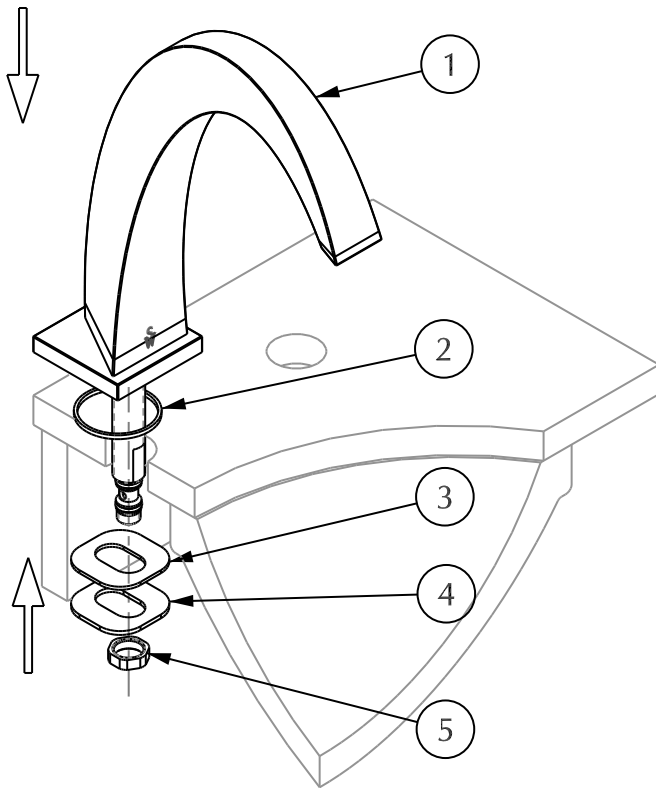

1. Insert spout assembly (1) through deck and ensure that counter gasket (2) is properly seated in spout escutcheon.
2. Slide rubber gasket (3) and metal bracket (4) onto spout shank and thread nut (5) onto shank until spout assembly (1) is firmly in place.

2B

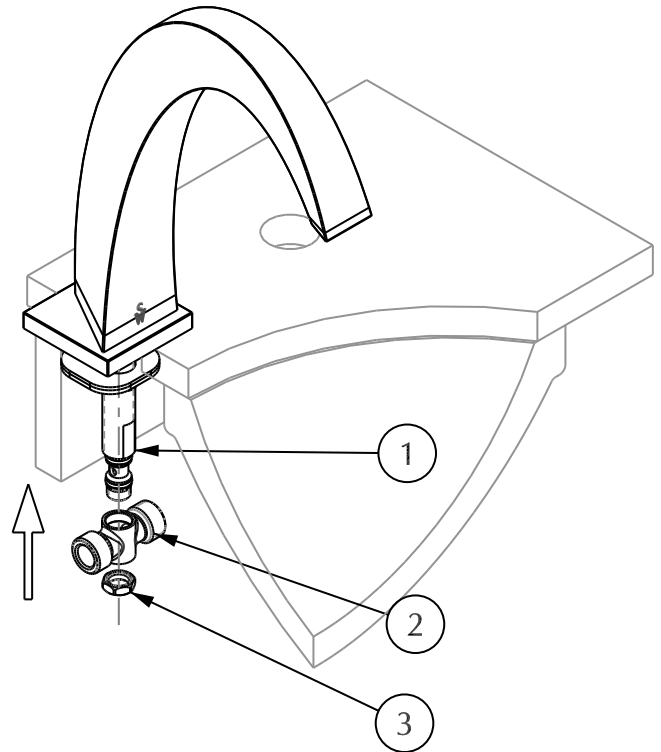

1. Slide inlet tee (2) over inlet nipple (1) and thread nut (3) onto inlet nipple (1) until tight.

108SPT Spout Installation - Without Escutcheon

1C

2C

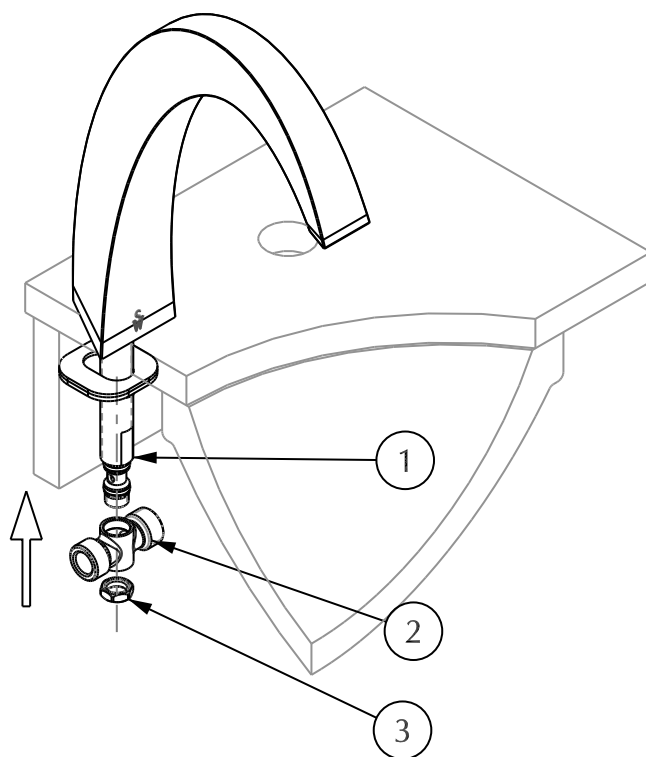
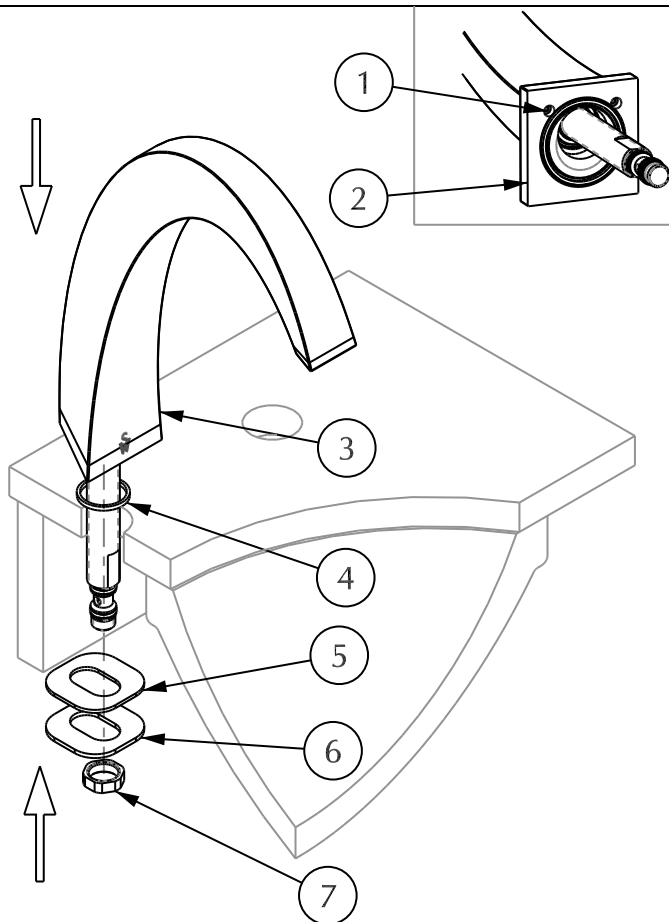

1. Unthread two screws (1) using a 3/32 hex wrench (not included) and remove escutcheon (2) from the bottom of spout.
2. Insert spout assembly without escutcheon (3) through deck and ensure that counter gasket (4) is properly seated in bottom of spout.
3. Slide rubber gasket (5) and metal bracket (6) onto spout shank and thread nut (7) onto shank until spout assembly (3) is firmly in place.

1. Slide inlet tee (2) over inlet nipple (1) and thread nut (3) onto inlet nipple (1) until tight.

109SPT Spout Installation

1D

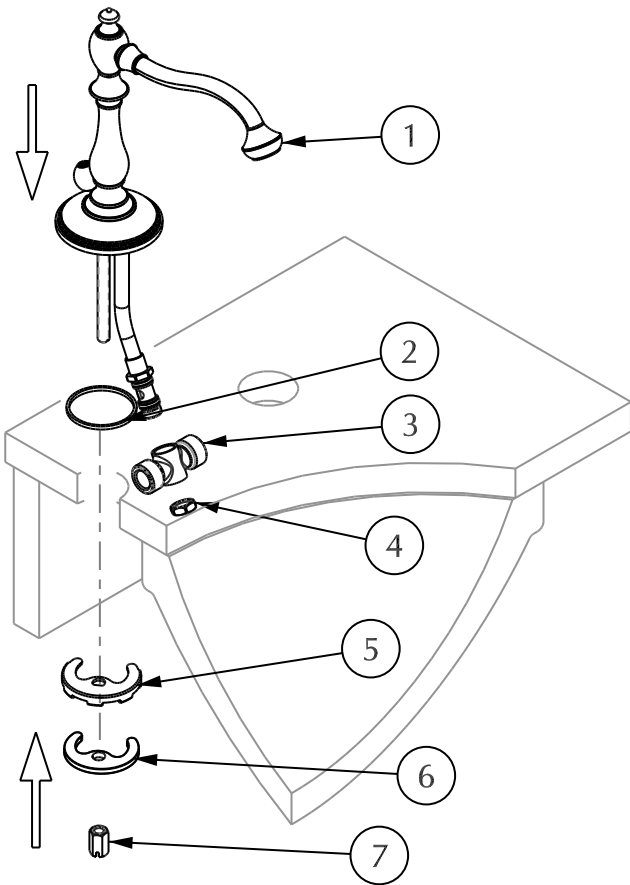

1. Remove nut (4) and tee connect (3) from spout assembly (1).
2. Insert spout assembly (1) through deck and ensure that counter gasket (2) is properly seated in bottom of spout.
3. Slide rubber gasket (5) and metal bracket (6) onto spout shank and thread nut (7) onto shank until spout assembly (1) is firmly in place.

2D

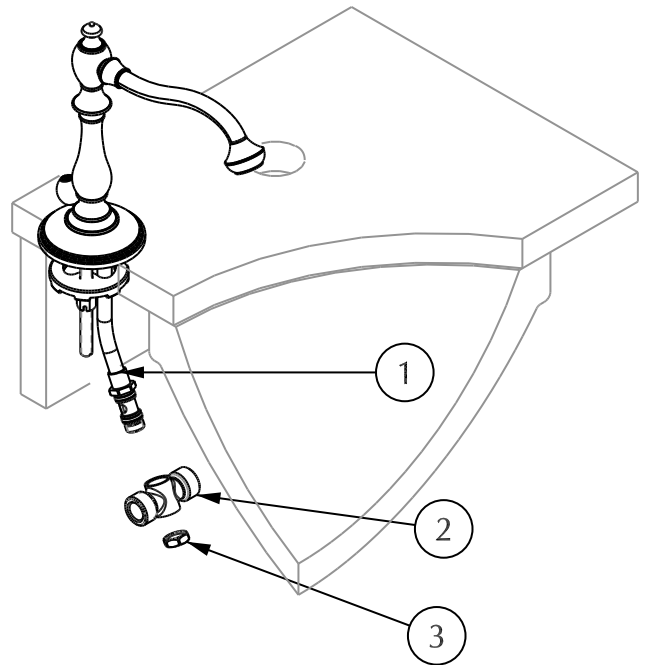

1. Slide tee connect (2) over inlet nipple (1) and thread nut (3) onto inlet nipple (1) until tight.

001HDL/002HDL/003HDL/008HDL Handle Installation

3

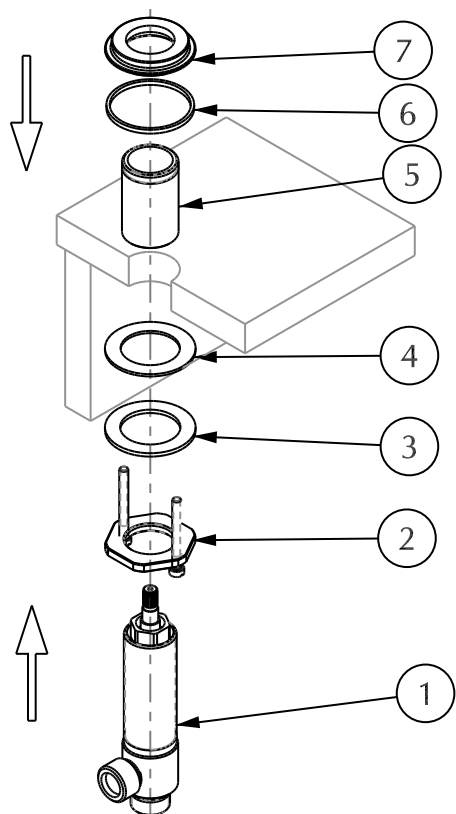

1. Thread mounting nut (2) onto cold end valve (marked with blue label).
2. Slide metal washer (3) and rubber gasket (4) onto end valve (1), then place end valve (1) up through deck from below.
3. From above the deck, thread valve extension sleeve (5) onto end valve (1) until securely fastened, slide rubber gasket (6) over extension sleeve (5), then thread valve mounting adapter (7) onto valve extension sleeve (5).

4

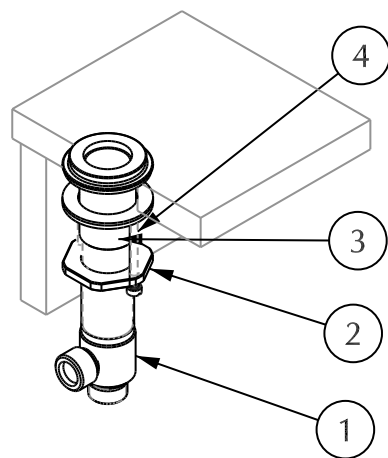

1. Position end valve (1) with side outlet pointing towards spout, then thread mounting nut (2) on end valve (1) until mounting nut is approximately 1/4" from the bottom of valve extension sleeve (3) or until it bottoms out on deck surface.
2. Thread jack screws (4) into mounting nut (2) and tighten jacks screws evenly with a screw driver until end valve is secured. Adjust mounting nut as needed to allow for clearance for the mounting jack screws.
3. Turn cartridge stem counterclockwise (clockwise for hot side) until stem stops. Valve is now in the closed position.

001HDL/002HDL/003HDL/008HDL Handle Installation

5A

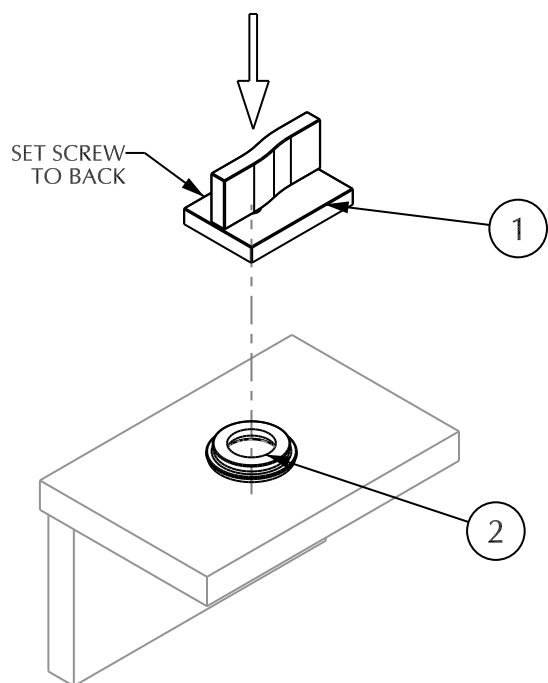

1. 001, 002 and 008 handle assemblies are unique for hot and cold sides. Make sure set screw hole in escutcheon is pointing towards the back as shown above.
2. Place handle assembly (1) over valve mounting adapter (2). Lever will engage cartridge stem below the deck. Take care to position lever in a straight line in the full off position. If lever is not straight, remove and adjust position on stem. If lever is still not able to be placed straight, loosen valve and rotate valve to adjust lever straightness. Retighten valve.

6A

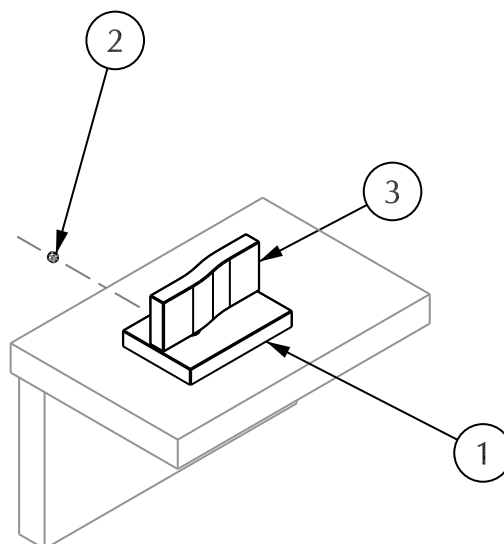

1. Position escutcheon (1) in straight line relative to lever (3) and tighten set screw (2).
2. Rotate lever (3) in order to ensure proper operation.
3. Repeat steps 3, 4, 5 and 6 for the hot end valve (marked with red label) and hot handle assembly.

009HDL Handle Installation

5B

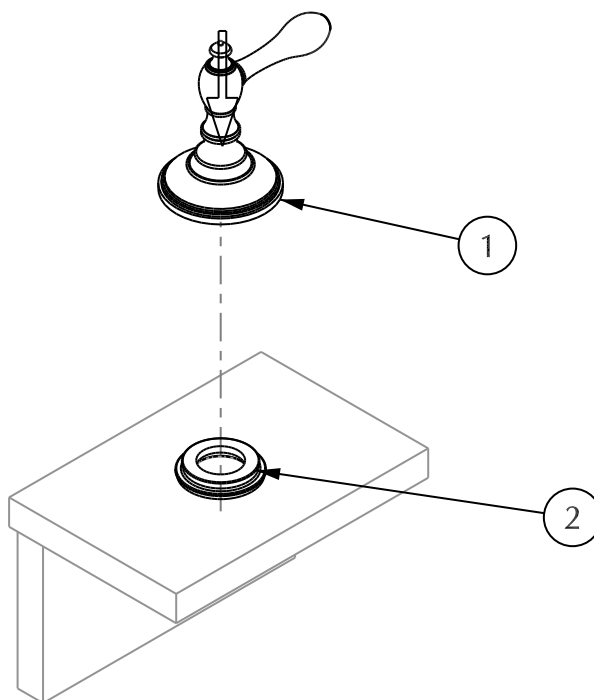

1. Thread handle assembly (1) over valve mounting adapter (2). Lever will engage cartridge stem below the deck. Take care to position lever in a straight line in the full off position. If lever is not straight, remove and adjust position on stem. If lever is still not able to be placed straight, loosen valve and rotate valve to adjust lever straightness. Retighten valve.
2. Repeat point 1 to install the other handle.

All Spouts - Water Supply Connection

7

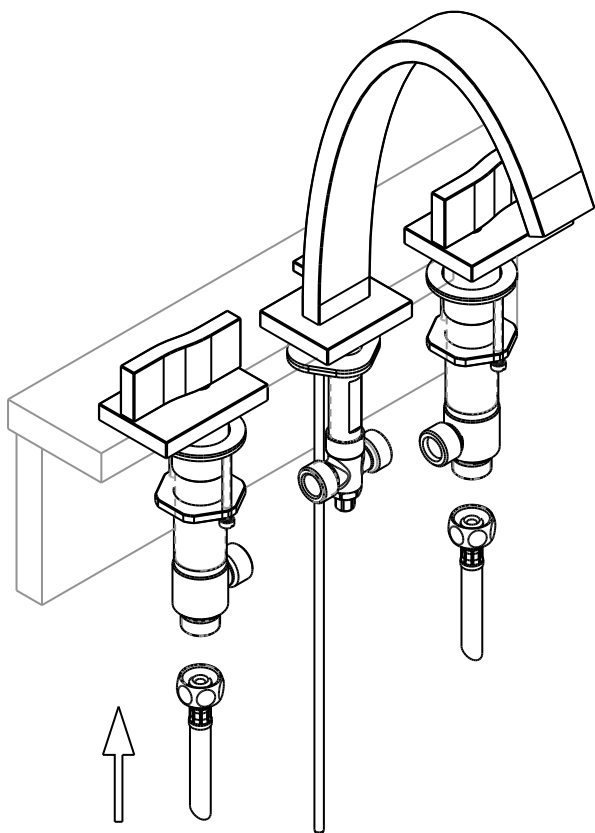

1. Make connections to water supply lines. (Supply lines not included.)
2. **IMPORTANT:** 101/102/103 spouts have integrated flow restrictors and the water lines must be flushed **BEFORE SPOUT ASSEMBLY IS CONNECTED TO VALVES**. Flushing water lines with spout connected prior to flushing lines may result in damage to flow restrictors.

8

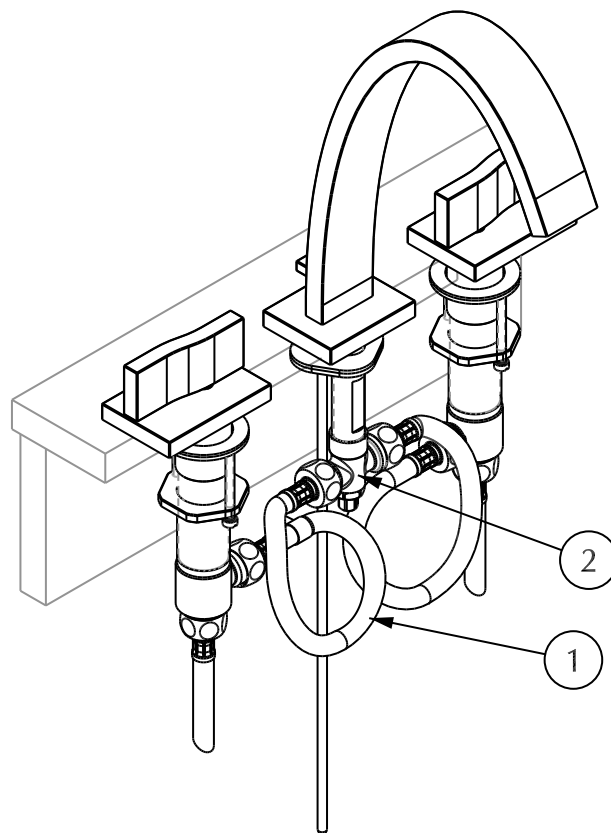

1. Connect supply hoses (1) included to spout inlet tee (2). Hand tighten hose connections plus 1/4 turn with a wrench.
2. For 101/102/103 models, proceed to Step 9A. For 108 model, proceed to Step 9B (Page 13).

Standard Pop-Up Waste Installation

9A

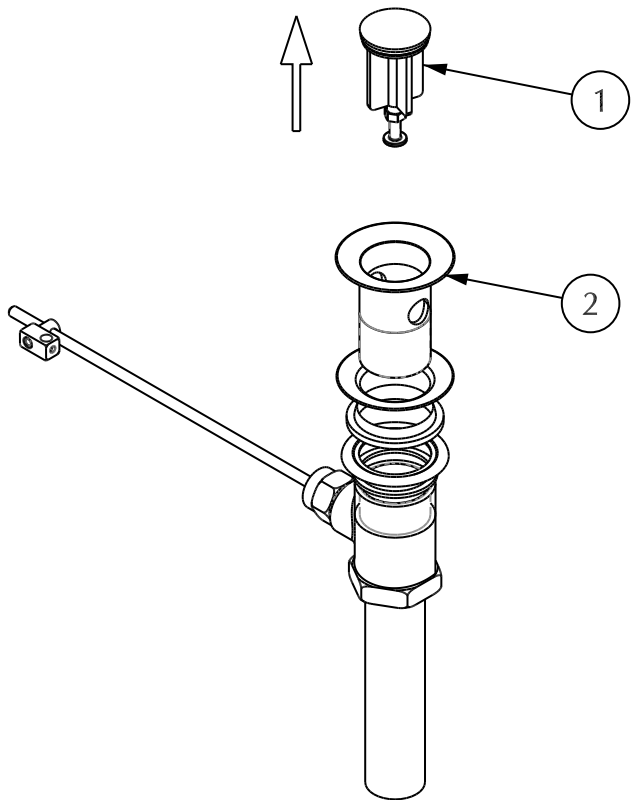

1. Remove stopper (1) and flange (2).

10A

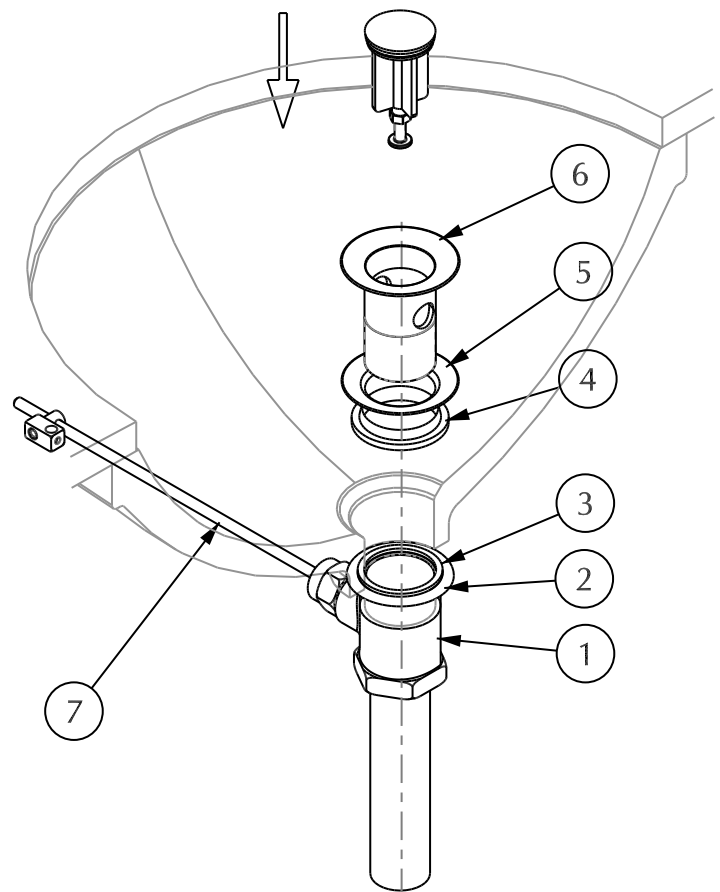

1. Place rubber gasket (3) and washer (2) onto body (1).
2. Slide gasket (4) and rubber washer (5) onto flange (6). NOTE: Rubber washer (5) can be replaced with caulking or other suitable sealing for the sink material.
3. Screw flange (6) into body (1).
IMPORTANT: PIVOT ROD (7) MUST POINT BACK TOWARDS SPOUT LIFT ROD.

Standard Pop-Up Waste Installation

11A

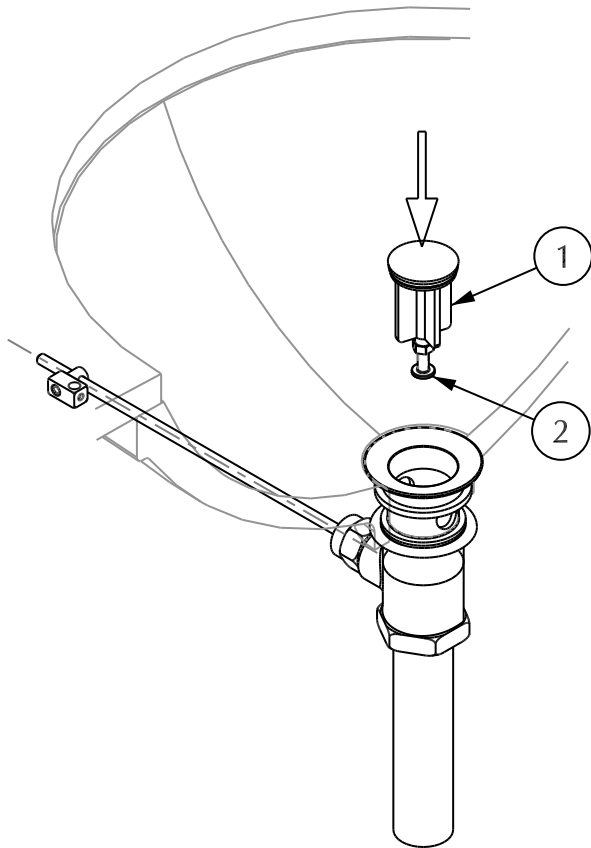

3. Insert the stopper (1). Adjust stopper screw (2) as needed to allow for proper operation.

12A

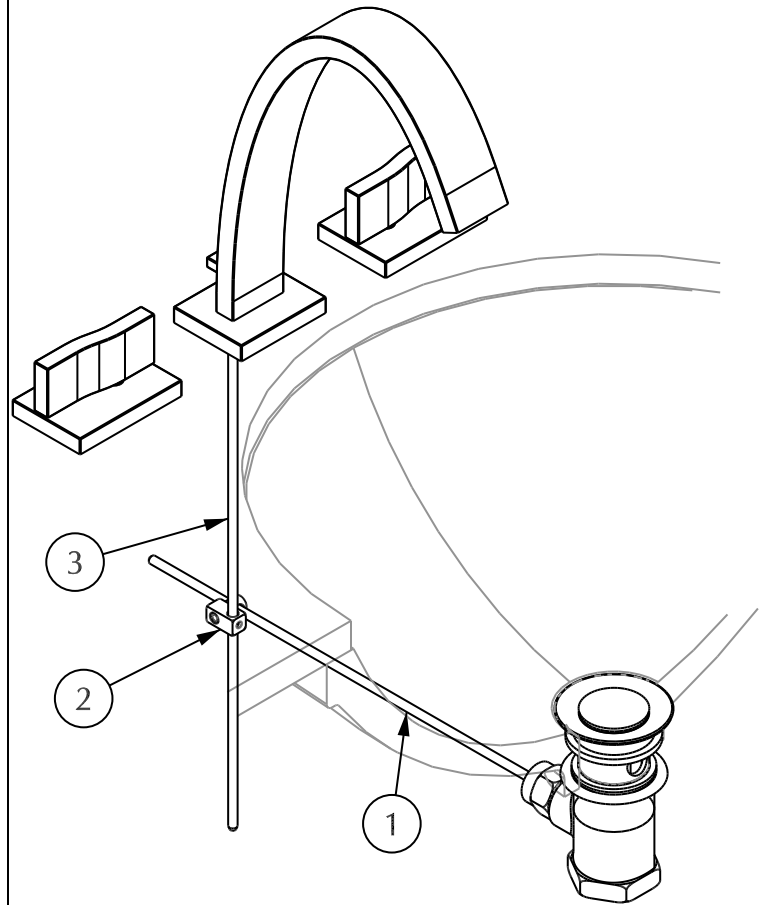

1. Push pivot rod (1) down to place pop-up in full open position. Check that lift rod (3) is in full down position.
2. Attach pivot rod (1) to lift rod (3) using adapter (2).
3. Connect drain pipe to bottom of pop-up waste.

Note: If lift rod (3) does not reach adapter (2), proceed to step 13A to install lift rod extension strap.

Standard Pop-Up Extension Installation

13A

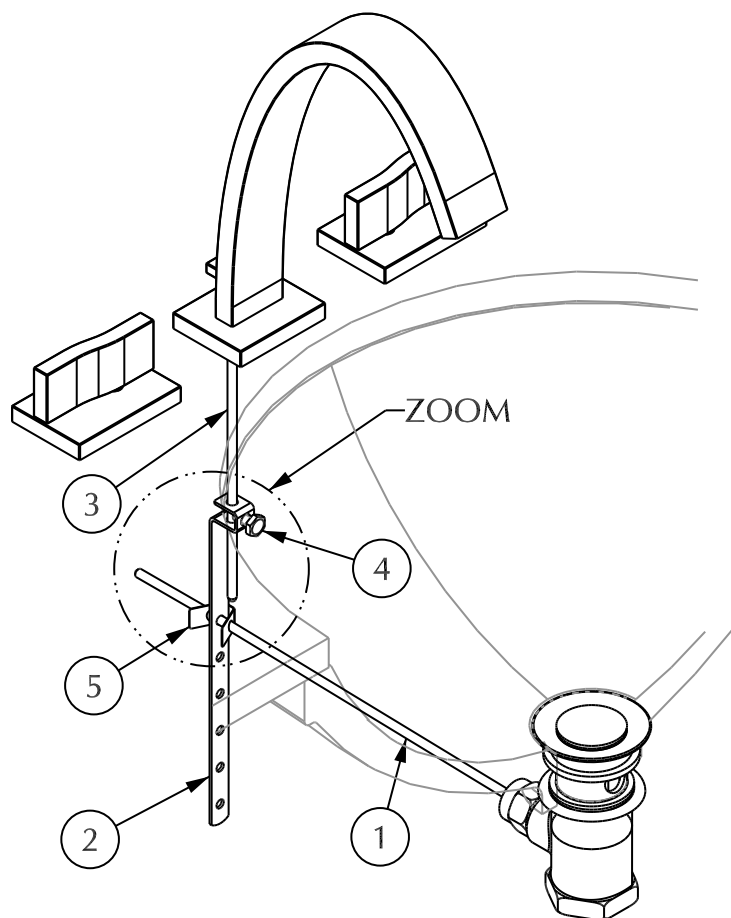

ZOOM

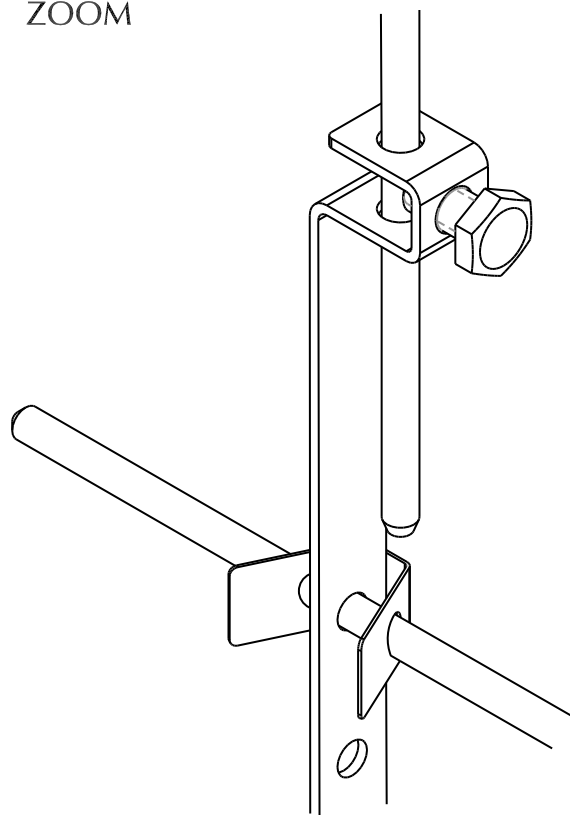

1. Push pivot rod (1) down to place pop-up in full open position.
2. Attach strap (2) to pivot rod (1) using clip (5). Install lift rod (3) in full down position.
3. Thread bolt (4) until tight.
4. Connect drain pipe to bottom of pop-up waste.

Click Pop-Up Waste Installation

9B

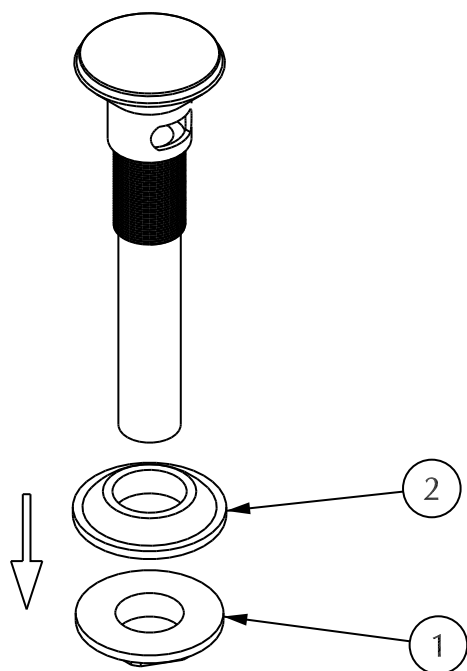

1. Remove nut (1) and rubber gasket (2).

10B

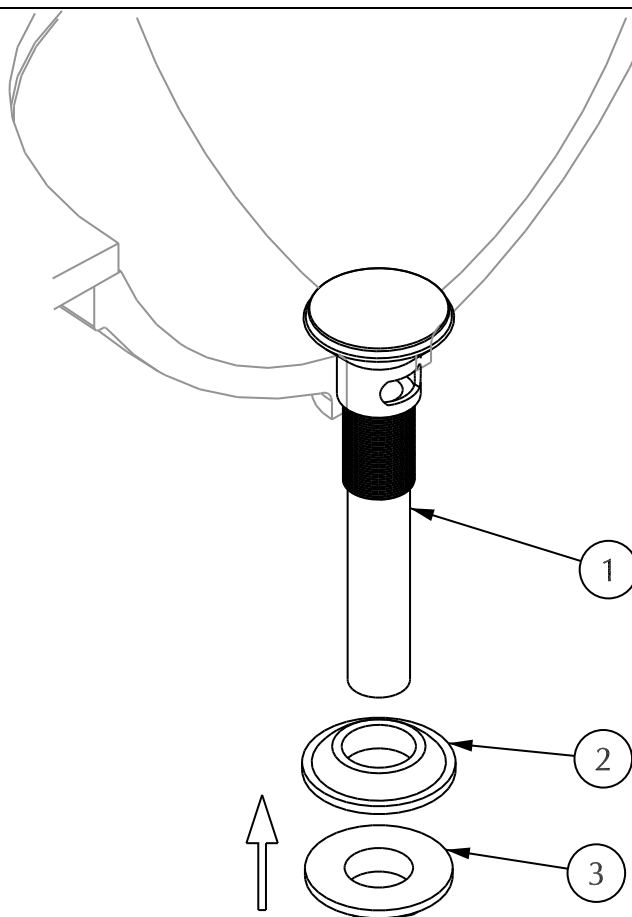

1. Insert the pop up body (1) from top side of sink.
2. Slide gasket (2) onto the body and thread the nut (3) onto the body from below deck until the body is firmly on place.
3. Connect drain pipe to bottom of pop-up waste.

14

Cartridge Replacement

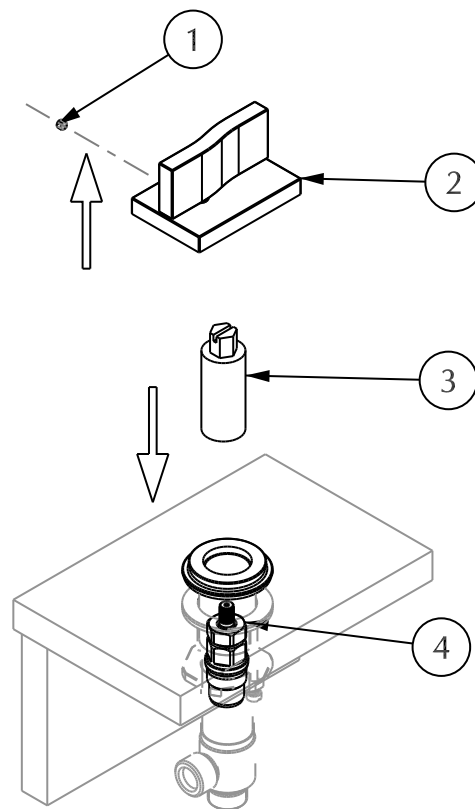
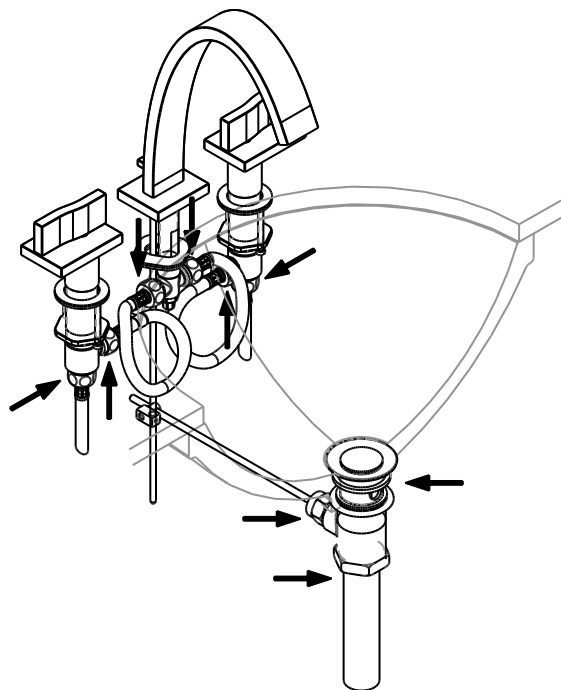

1. Turn faucet handles to full open position. Check all connections at arrows for leaks. Retighten connections if necessary.

1. Loosen set screw (1) and remove handle assembly (2).
2. Using a 3/4" deep well socket (3), unthread cartridge (4) from body.
3. Using a 3/4" deep well socket (3), install new cartridge into valve body.

101-001-BSN/102-002-BSN/103-003-BSN Parts List

ITEM	PART NUMBER	DESCRIPTION
1	11926	10-24/10-32 X .1875 Set Screw
2	10152	End Valve Assembly - Hot
	10153	End Valve Assembly - Cold
3	10609	Deck Adapter Kit
4	10018	Gasket
5	10583	End Valve Mounting Kit
6	10039	Cartridge - Hot
	10137	Cartridge - Cold
7	10023	Inlet Tee Nut
8	10376	Inlet Tee
9	10379	O-Ring
10	10382	Inlet Nipple
11	10381	Rubber Gasket
12	10455	Metal Washer
13	10383	1.5 GPM Flow Restrictor
14	10467	Spout Mounting Kit
15	10619	Aerator & Wrench Kit
16	10406	M3 x 4 Set Screw
17	10469*	Lift Rod Assembly
18	10402	Cartridge Removal Tool
19	11500	Hose

* SPECIFY FINISH WHEN ORDERING

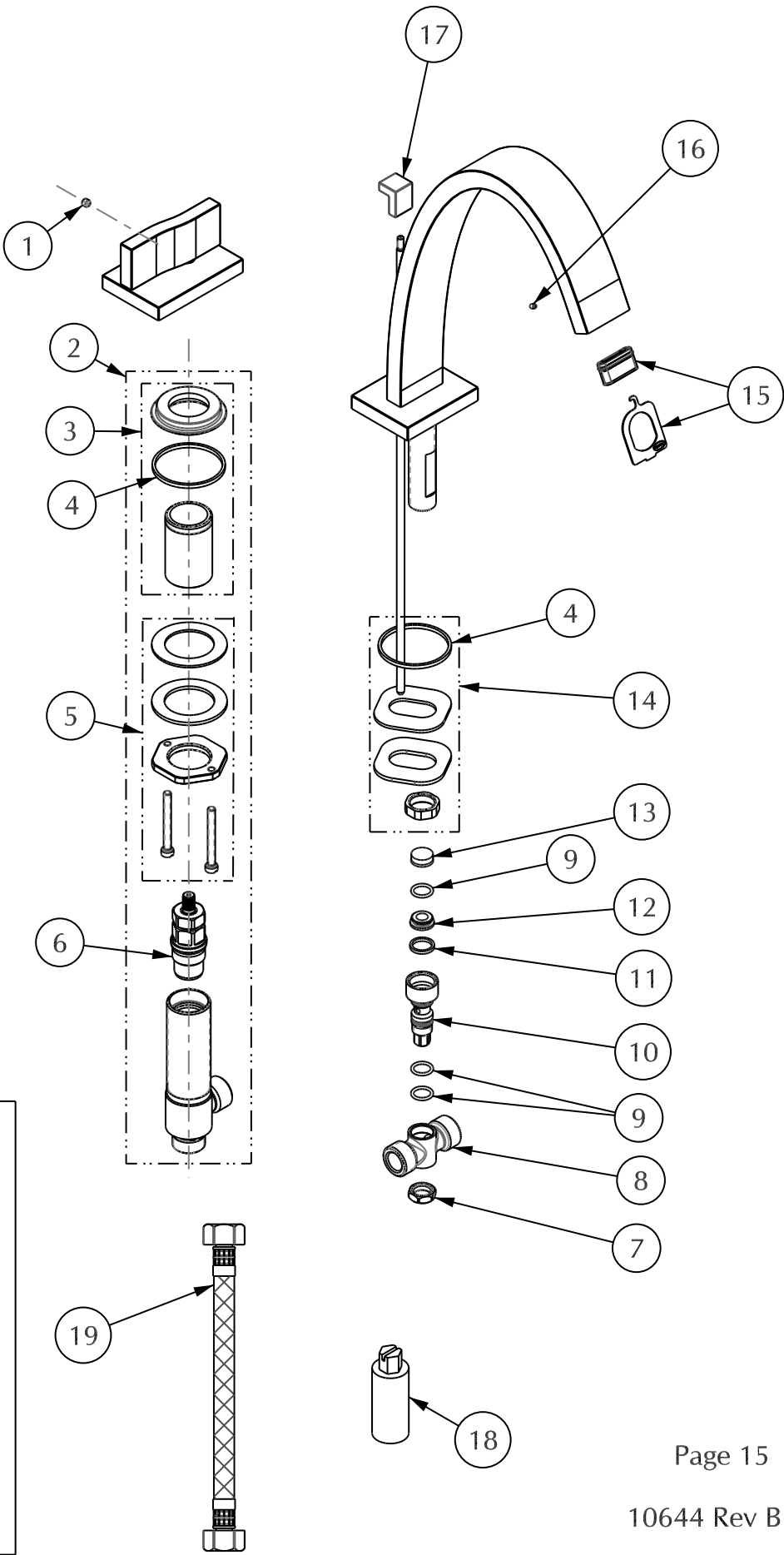

10131* Standard Pop-up Assembly

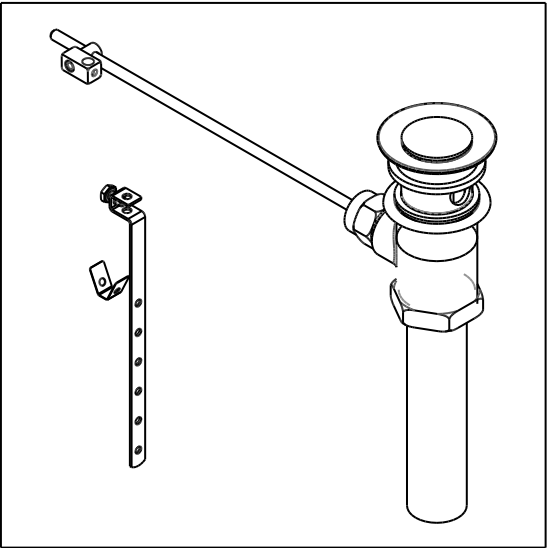

108-008-BSN Parts List

ITEM	PART NUMBER	DESCRIPTION
1	11926	10-24/10-32 X .1875 Set Screw
2	10152	End Valve Assembly - Hot
	10153	End Valve Assembly - Cold
3	10609	Deck Adapter Kit
4	10018	Gasket
5	10583	End Valve Mounting Kit
6	10039	Cartridge - Hot
	10137	Cartridge - Cold
7	10023	Inlet Tee Nut
8	10376	Inlet Tee
9	10379	O-Ring
10	10467	Spout Mounting Kit
11	10620	Aerator & Wrench Kit
12	10402	Cartridge Removal Tool
13	11500	Hose

* SPECIFY FINISH WHEN ORDERING

10621* Click Pop-up Assembly

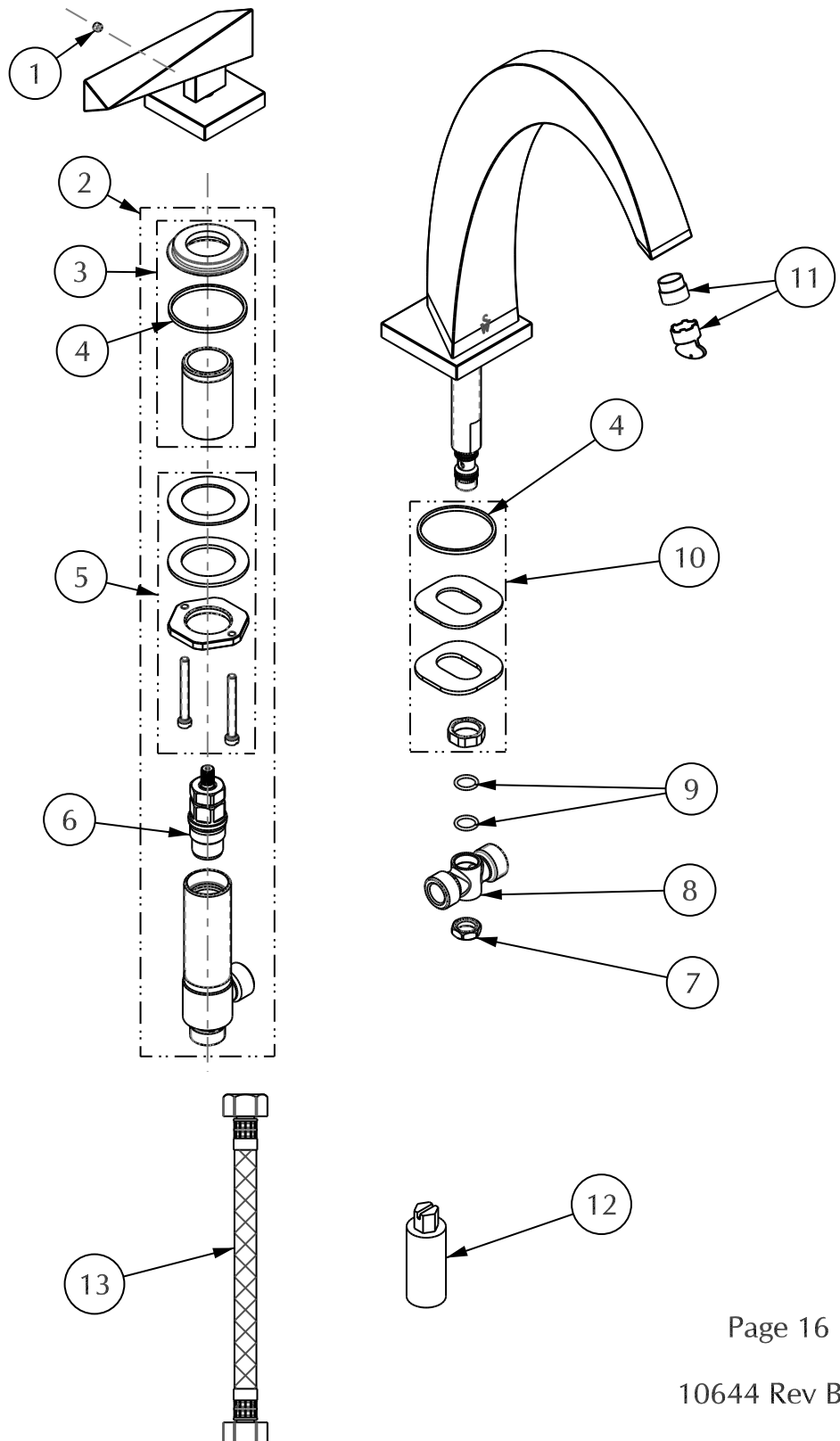
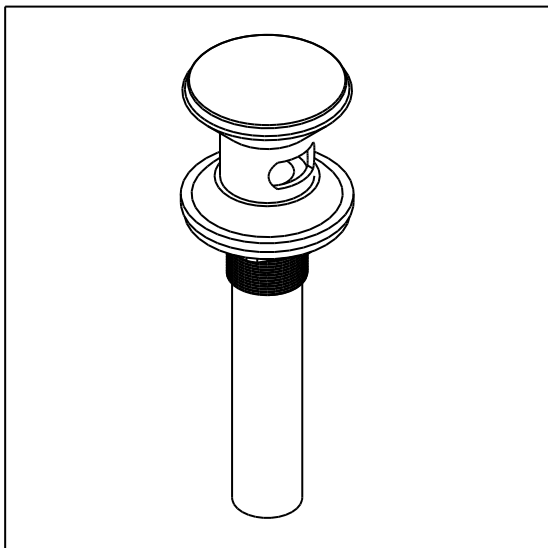

109-009-BSN Parts List

ITEM	PART NUMBER	DESCRIPTION
1	10150	End Valve Assembly - Hot
	10151	End Valve Assembly - Cold
2	10582	Deck Adapter Kit
3	10018	Gasket
4	10583	End Valve Mounting Kit
5	10039	Cartridge - Hot
	10137	Cartridge - Cold
6	10590	Spout Mounting Kit
7	10023	Nut
8	10376	Inlet Tee
9	10379	O-Ring
10	10620	Aerator & Wrench Kit
11	12268*	Lift Rod Assembly
12	11500	Hose

* SPECIFY FINISH WHEN ORDERING

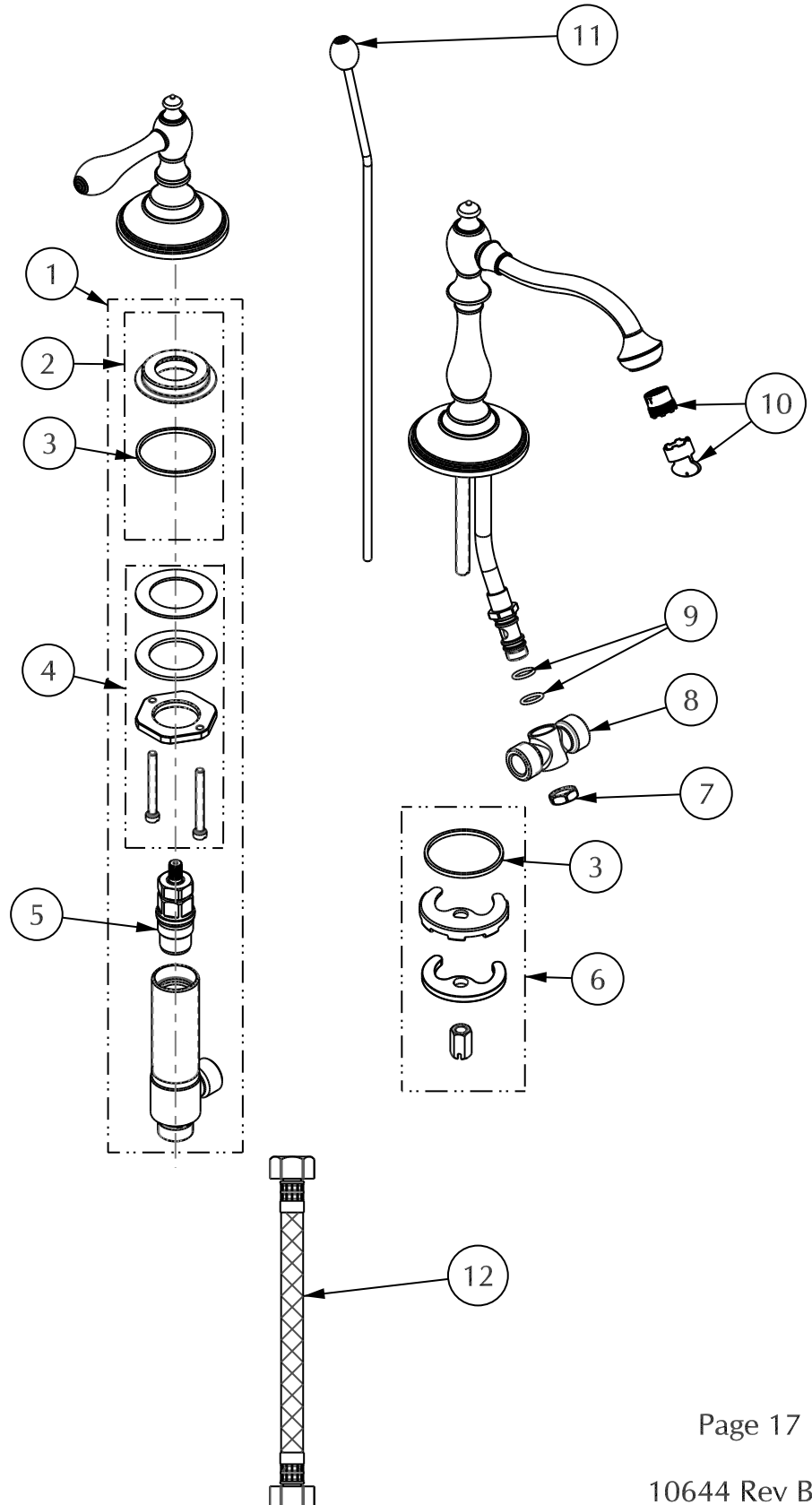

10131* Standard Pop-up Assembly

