

Built-in sensor tap, 190mm

Qtoo collection

Product 190mm infrared sensor tap for wall installation

Tender text QTOO collection, sensor tap for wall.
Manufactured in the highest quality marine grade, AISI 316 stainless steel, protecting against high levels of corrosion and securing cleaner drinking and utility water.

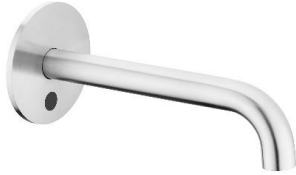

Product specification Projection: 190mm - 7 1/2"
Rose Ø90mm - 3 1/2" with integrated sensor
Built in aerator
Max. flow rate: 5L - 1,3gpm
Comfort time out 2 sec.
Security time out 30 sec.
Automatic rinse cycle (deactivated)
Always secure min. 140mm - 5 1/2" distance from aerator to washbasin waste
Use with Flexbox QSF01 and connector QS3400
Temperature control in Flexbox
Max. work pressure 8 bar
Including 920mm - 36 7/32" cable
Lead free compliant
Material: Marine grade AISI 316 stainless steel
[20-year warranty \(5 years for coated items\)](#)

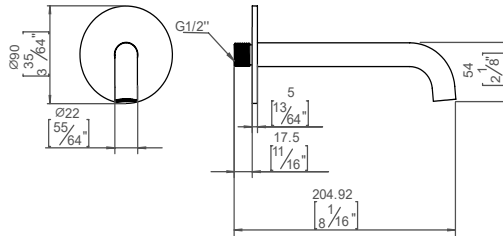

Available finishes

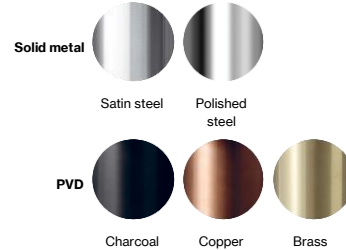

Spare parts/ accessories QSF01 - Premix Flexbox
QS3400 - Built in spout connector

Mounting <https://dline.com/mounting-instructions/>

Product care

d line products are produced in the highest quality marine grade AISI 316 stainless steel. To sustain the unique d line finish please follow the below instructions:

- Wash down the surfaces using soapy water or mild detergent
- Always thoroughly rinse off with clean water
- To complete the cleaning procedure dry/polish the surface with a soft dry cloth

Please do not use scouring powder, steel wool, chloride based detergents or other aggressive cleaning products as these may damage the surface.

If spots or corrosion appear on the surface it is not due to the stainless steel quality, but to impurities in the environment, aggressive conditions or improper or insufficient cleaning.