

For Residential and Commercial Applications

Job Name		Engineer / Architect	
Job Location		Wholesaler	
Submittal Date		Contractor	

PLB203/212X 1/4 Turn Straight Ball Stop - Sweat x Compression

Use: For use only in potable water distribution systems, hot and cold, in accessible locations only

Part Listing:

- PLB203X B 1/2" nom sweat x 3/8" OD compression, chrome plated, bulk
- PLB203X P 1/2" nom sweat x 3/8" OD compression, chrome plated, bagged
- PLB212X P 1/2" nom sweat w/extension tube x 3/8" OD compression w/bell escutcheon, chrome plated, bagged



Operating Specifications	
Temperature	Pressure
Intermittent 40° - 160° F	125 PSI maximum

MATERIAL SPECIFICATIONS	
Body	Brass, plated
Stem	Brass
Ball	Brass, plated
Seats	PTFE
O-ring	Rubber
Handle	Zinc, plated
Handle Screw	Stainless steel
Compression Nut	Brass, plated
Compression Sleeve	Brass
Adaptor	Brass, plated

This specification and all information contained herein is the confidential and exclusive property of Brasscraft Manufacturing Company, and shall not be disclosed to others without the written consent of Brasscraft Mfg. Co. This specification must be returned to Brasscraft Mfg. Co. if requested.

PLB203/212X 1/4 Turn Straight Ball Stop - Sweat x Compression

PART DIMENSIONS (Inches)					
Model	DIM. A	DIM. B	DIM. C	DIM. D	DIM. E
PLB203X	1.77	1.12	1.50	2.07	.94
PLB212X	1.77	1.50	2.40	N/A	.94

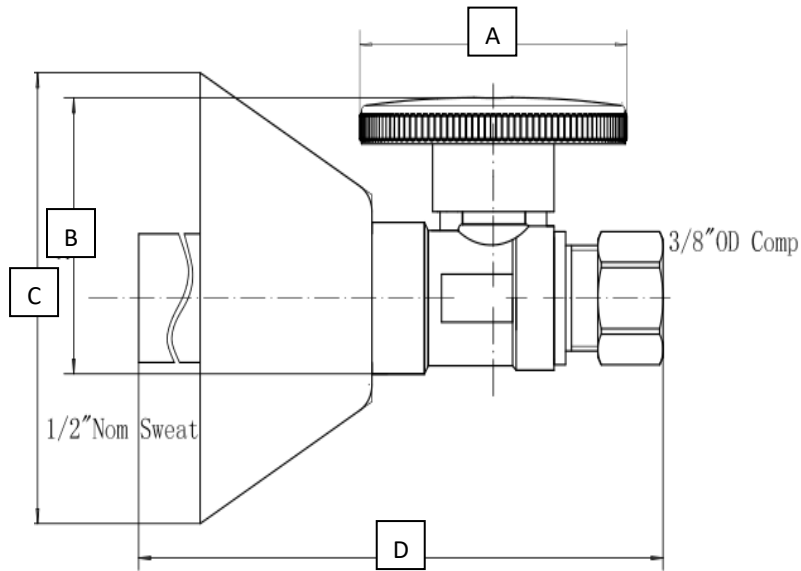
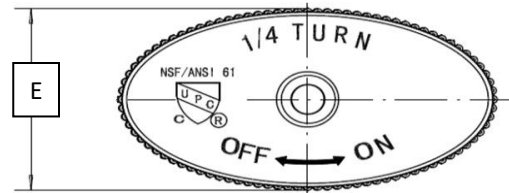
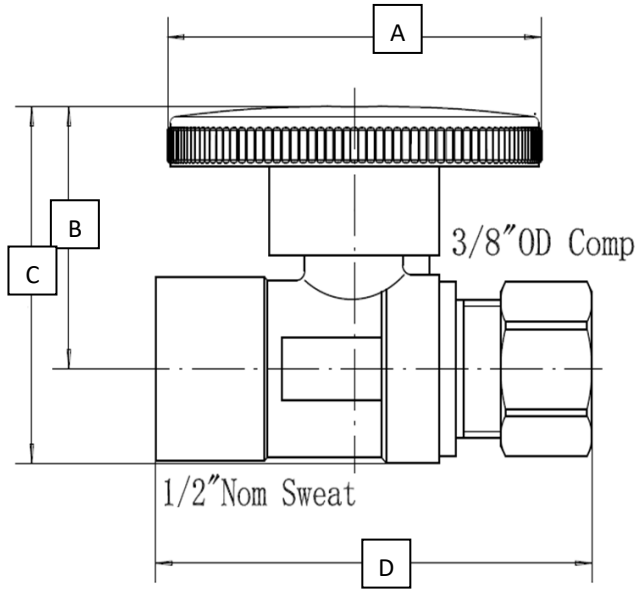

Listings & Certifications:

- IAPMO listed to ASME A112.18.1 / CSA B125.1 (includes NSF/ANSI 372 and NSF/ANSI/CAN 61)



This specification and all information contained herein is the confidential and exclusive property of Brasscraft Manufacturing Company, and shall not be disclosed to others without the written consent of Brasscraft Mfg. Co. This specification must be returned to Brasscraft Mfg. Co. if requested.

PLUMBSHOP®