

# FLATIRON MUS-503GDSB

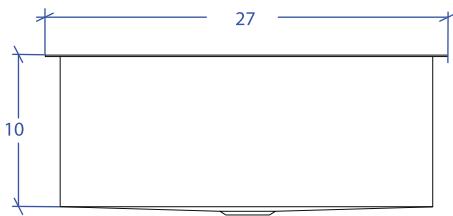

\*Custom ADA compliant versions are available

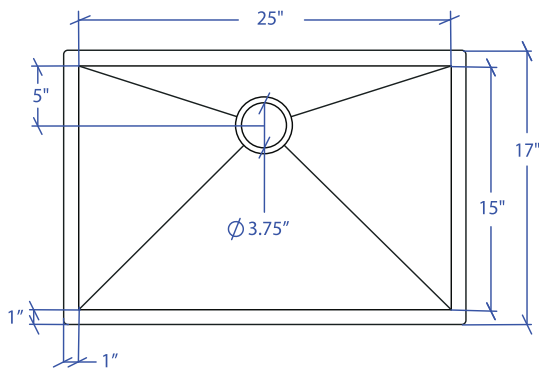

## • FEATURES

- 16-gauge type 304 stainless steel
- 90° zero radius design

## • TECHNICAL INFORMATION

- External dimension: 27"Lx17"Wx10"D
- Basin dimensions: 25"Lx15"Wx10"D

## • FINISHES

- Gold PVD Satin Brushed stainless steel

## • INSTALLATION OPTIONS

- Top-mount
- Under-mount

## • MINIMUM CABINET SIZE (I.D.)

- Top-mount 28"
- Under-mount 30"

## • DUAL-MOUNT INSTALLATION

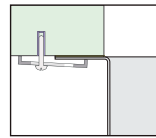

Under-mount

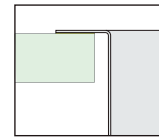

Top-mount

## • ACCESSORY OPTIONS

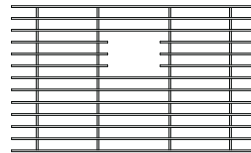

MBG-055GDSB  
Basin Grid

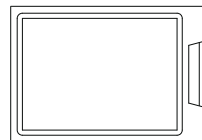

MCB-501BB  
Cutting Board

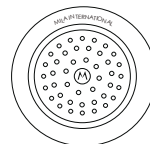

MKD-101GDSB  
Strainer

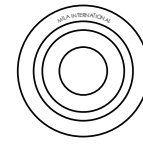

MDC-101GDSB  
Disposal Collar

PROJECT INFORMATION			
Project			
Date	/ /	QTY	
Specifier			
Contact			
Note			