

A³form

Technical data sheet



Washplace

Unit.SR2

Article number: 5147 620 620

Design partner: Alape

Features

Name	Unit.SR2
Article number	5147 620 620
Standard colour washstand covering	White
Furniture surface	Wood effect laminate Grey oak
Construction	with faucet hole and overflow, base cabinet with full depth drawer, soft close, chrome-plated handle, without siphon cutout
Dimensions	27½ x 20⅝ x 12⅝",
Material washstand covering	Glazed steel
Material furniture	Wood effect laminate (HPL)
Net weight	25 kg
Installation	for wall connection
Accessoires	including space-saving trap
Faucet information	Optimum point of impact approx. 4⅛ – 6⅛" from centre of tap hole. Faucets with a vertical outlet and aerator provide the optimum flow of water onto the surface below (angle of impact: 90°).

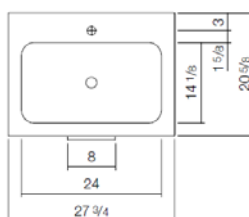
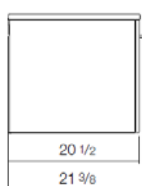
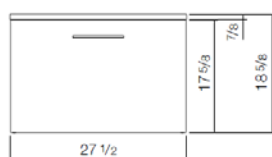

Text for invitation to tender

Washplace, rectangular, 27½ x 20⅝", height 12⅝", rectangular basin mould centred, with faucet hole and over flow, washstand covering glazed inside and outside, base cabinet with full depth drawer, soft close, chrome plated handle, furniture surface wood effect laminate Grey oak, internal drawer without siphon cutout, including space-saving trap, installation kit and over flow set, without dowels (to be adjusted to constructional situation)

Brand: Alape

Model: Unit.SR2